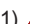

Service & maintenance instructions

- (1)  Before servicing or dismantling a component, ensure that the appliance is disconnected from the power source.
- (2) Remove the drain hose from the inlet opening and carefully dismantle the outlet pipe from the non-return valve so that the water in the outlet pipe does not splash over the floor or the pump.
- (3) Remove the container from the main plate.
- (4) Make sure that the float bodies move freely. Clean if necessary.
- (5) Clean the container with warm water and mild soap.
- (6) Check the inlet and outlet lines. Clean if necessary. Make sure that there are no kinks in the pipe that could obstruct the flow.
- (7) After maintenance, reassemble the appliance in reverse order.
- (8) In the event of a longer interruption, remove the water from the outlet pipe and the storage tank

Problem solving

The device is not running.	<ol style="list-style-type: none"> a) Check the power supply. b) Check the appliance to determine whether condensation is actually forming. c) Make sure that the inlet pipe is not blocked. If it is blocked, the appliance may be damaged.
The appliance makes loud noises during operation.	<ol style="list-style-type: none"> a) Make sure that the inside of the container is clean. b) Make sure that no emptying action is being performed.
The appliance runs, but does not pump out the liquid.	<ol style="list-style-type: none"> a) Make sure that the highest point of the outlet pipe does not exceed the maximum delivery head of the pump. b) Check that the inside of the outlet pipe is clean. c) Check the non-return valve according to the maintenance instructions
Liquid escapes from the from the non-return valve.	<ol style="list-style-type: none"> a) Make sure that the outlet pipe is firmly connected to the non-return valve. b) Ensure that the non-return valve is properly attached.

Limited warranty

The **AKTOBIS** condensate pump is warranted against defects in materials and workmanship for a period of 12 months. Any product that fails for either of the above reasons and is still within the warranty period will be repaired or replaced at the option of Sungshin Hasco Ltd. as the purchaser's sole remedy.

For our customers outside Korea, the seller's warranty periods apply. Please return the defective device to your point of sale with a brief written explanation of the problem. If there are no obvious signs of customer abuse, the device will be repaired or replaced. If there is a dispute when replacing the pump, the local dealer or distributor must or distributor must sort out these parts and arrange for an inspection by a representative of Sungshin Hasco Ltd. representative or contact the factory for details of the problem for factory adjustment and the settlement of warranty claims.

DISCLAIMER: The foregoing warranty is an exclusive warranty in lieu of any other express warranty. in lieu of any other express warranty. Implied warranties (including but not limited to implied warranties of merchantability, fitness for a particular purpose), insofar as they apply to a pump, are limited to the duration of the above express warranties stated above.

The warranty is void if any of the following conditions exist:

1. the sealed motor housing has been opened.
2. the product has not been connected to the voltage specified on the rating plate
3. the cable is blocked at a length of less than 3 feet
4. pump has run dry (interrupted fluid supply).
5. the pump was used to circulate something other than fresh water at approximately room temperature.
6. Any kind of product misuse by the customer.

Verbal statements made by the seller, the manufacturer, representatives or other parties about the product about the product do not constitute a warranty, are not accepted by the user and are not part of the sales contract. The sole obligation of the seller and the manufacturer manufacturer and the buyer's sole remedy is for the manufacturer to replace and/or repair the product as replace and/or repair the product as described above. Neither the seller nor the manufacturer shall be liable for any injury, loss or damage, direct, incidental or consequential (including, but not incidental or consequential damages for loss of profits, lost sales, personal injury or property damage or other incidental or consequential damages, personal injury, property damage or other incidental or consequential loss) arising out of the use or inability to use the product, and the user agrees that no other remedy is available to him. Prior to use, the user must suitability of the product for its intended use and assumes all risks and liabilities associated risks and liabilities. We recommend that each pump is fitted with an earth leakage circuit breaker (earth leakage stabiliser).

AKTOBIS AG
Borsigstr. 20
63110 Rodgau
061062842320
06106-2842315

info@aktobis.de
www.aktobis.de

No more bucket needed!
Aktobis condensate pumps are here for you.



USER MANUAL

Quiet, Modern, Reliable

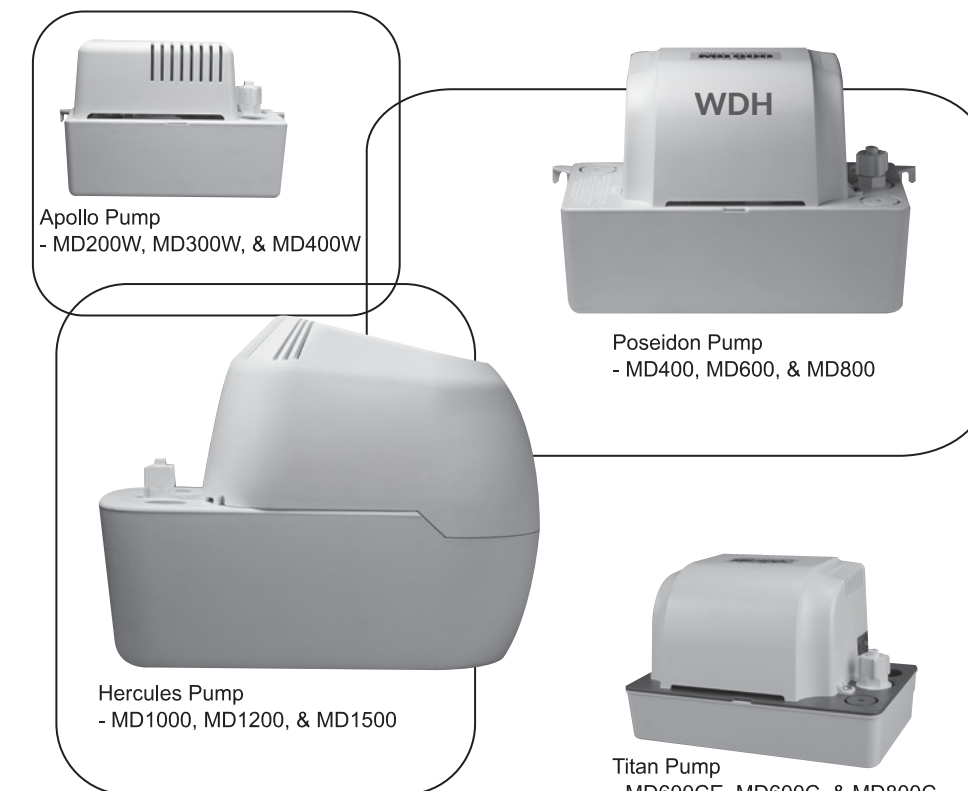

Intelligent security for your comfortable room!

Please read these operating instructions carefully before installing, operating or maintaining the AKTOBIS pump. Read these instructions on pump application, restrictions and possible dangers carefully. Protect yourself and others by observing all safety instructions. Failure to follow the instructions may result in personal injury and/or damage to property. Keep these operating instructions in a safe place for future reference. Installation, connection and customer service may only be carried out by a qualified person.

Aktobis condensate pumps are designed to automatically remove the drainage liquid produced by the air conditioning evaporator. Our pumps can also be used for other types of fresh water removal from cooling units, dehumidifiers, water dispensers, etc. where gravity drainage is not possible.

Device description

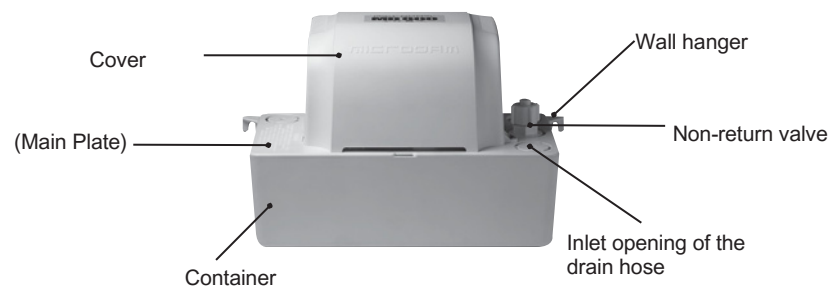

General functions

- Fully automatic operation
- Flame retardant & impact resistant plastic construction
- Low noise motor with thermal protection
- Stainless steel shaft accepted
- 90 degree non-return valve for easy maintenance
- Various designs for different installation locations

Warnings

1. DO NOT USE FLAMMABLE OR EXPLOSIVE FUELS SUCH AS PETROL, HEATING OIL, ALCOHOL, ETC.
2. DO NOT USE IN POTENTIALLY EXPLOSIVE ATMOSPHERES.
3. DO NOT USE TO PUMP HOT WATER ABOVE 40 DEGREES.
4. DO NOT HANDLE THE PUMP WITH WET HANDS OR ON WET OR DAMP SURFACES OR IN WATER.
5. TO REDUCE THE RISK OF ELECTRIC SHOCK, MAKE SURE THE PUMP IS PLUGGED INTO A PROPERLY GROUNDED OUTLET.
6. ONLY CONNECT THE PUMP TO THE POWER SUPPLY SPECIFIED ON THE PUMP RATING PLATE.
7. IN INSTALLATIONS WHERE PROPERTY DAMAGE AND/OR PERSONAL INJURY MAY BE CAUSED BY AN INOPERATIVE PUMP, A BACKUP SYSTEM AND/OR ALARM SHOULD BE USED.
8. DO NOT KINK OR TWIST THE DRAIN HOSE AND DRAIN HOSE.
9. BEFORE ANY MAINTENANCE OR REPAIR OF THE PUMP, THE PUMP MUST BE DISCONNECTED FROM THE POWER SUPPLY TO PREVENT ELECTRIC SHOCK.
10. PREVENT CHILDREN FROM ACCESSING THE PUMP.
11. PLEASE NOTE THAT THE PUMP IS NOT A SUBMERSIBLE PUMP.
12. ANY INSTALLATION OR SERVICE SHOULD BE PERFORMED BY A QUALIFIED SERVICE TECHNICIAN:
13. THE INTERMITTENT RATED CAPACITIES OF THESE PUMPS DO NOT EXCEED 5 MINUTES

Model specification

Poseidon - Pump - Standard model medium size

Model	Power supply	Capacity (l/hr@height (metres))					Water level	Ampere	Watt	Tank capacity
		0	2	4	6	8				
MD400	230V 60HZ	330	210	192	-	-	4.0m	0.72A	74	1.8ℓ
	230V 50HZ	360	240	192	-	-	4.0m	1.01A	85	
	230V 50HZ	348	240	192	-	-	4.0m	0.72A	74	
MD600	230V 60HZ	444	300	234	120	-	6.0m	0.89A	87	1.8ℓ
	230V 50HZ	402	264	204	-	-	5.5m	1.60A	117	
	120V 60HZ	396	276	234	120	-	6.0m	0.89A	87	
MD800	230V 60HZ	504	402	258	156	156	8.0m	1.25A	125	1.8ℓ
	230V 50HZ	432	276	225	99	-	6.6m	2.48A	195	
	120V 60HZ	510	384	258	162	156	8.0m	1.25A	125	

Titanium pump - Medium-sized model with flat reservoir

Model	Power supply	Capacity (l/hr@height (metres))					Water level	Ampere	Watt	Tank capacity
		0	2	4	6	8				
MD600C	230V 60HZ	360	246	228	120	-	6.0m	0.89A	85	1.8ℓ
	120V 60HZ	336	246	228	120	-	6.0m	0.89A	85	
MD800C	230V 60HZ	450	276	254	156	144	8.0m	1.25A	117	1.8ℓ
		450	270	254	150	144	8.0m	1.25A	117	
MD600CE	230V 50HZ	336	228	204	84	-	6.0m	0.64A	75	1.8ℓ

Apollo - Pump - Compact model for wall-mounted air conditioners only

Model	Power supply	Capacity (l/hr@height (metres))					Water level	Ampere	Watt	Tank capacity
		0	2	4	6	8				
MD200W	120V 60HZ/	222	156	150	-	-	2.5m	0.29A	32	1.8ℓ
	230V 60HZ									
MD300W	230V 60HZ	234	210	162	78	-	3.0m	0.35A	34	1.8ℓ
	230V 50HZ	180	137	132	-	-	2.4m	0.44A	42	
MD400W	120V 60HZ	240	168	162	90	-	3.0m	0.35A	34	1.8ℓ
	230V 60HZ	288	240	198	162	114	4.0m	0.66A	43	
	230V 50HZ	216	165	150	108	-	3.0m	1.12A	71	1.8ℓ
	120V 60HZ	270	192	186	162	114	4.0m	0.66A	43	

Hercules - Pump - extra large model

Model	Power supply	Capacity (l/hr@height (metres))					Water level	Ampere	Watt	Tank capacity
		0	2	4	6	8				
MD1000	230V 60HZ	648	366	204	-	-	10.0m	0.91A	240	3.8ℓ
	230V 50HZ	630	630	156	-	-	9.0m	0.72A	150	
	120V 60HZ	630	390	180	-	-	10.0m	0.91A	240	
MD1200	230V 60HZ	648	372	372	168	-	12.0m	0.72A	150	3.8ℓ
	230V 50HZ	630	348	168	130	-	11.0m	0.99A	250	
	120V 60HZ	648	390	186	168	-	12.0m	0.98A	180	
MD1500	230V 60HZ	790	462	270	252	240	15.0m	0.99A	250	250
	230V 50HZ	690	360	180	162	84	14.0m	0.98A	0.98A	
	120V 60HZ	720	450	270	216	198	15.0m	0.99A	250	

⚠ The above models and specifications are subject to change without notice for functional improvements.

Installation instructions

(1) Carefully unpack the appliance and check it for damage. Ensure that all necessary parts are included. The units are thoroughly tested before packing to ensure safe delivery and operation. If there are any signs of shipping damage, return it to the point of purchase for repair or replacement.

(2) Select an installation location close to the appliance. The pump must be installed horizontally. Lay flexible hoses or pipes from the evaporator drain into the inlet opening of the pump. Make sure that the inlet pipe is inclined downwards so that it can drain by gravity. can drain by gravity.

(3) Connect the outlet pipe (3/8" internal diameter) to the non-return valve. Extend the outlet pipe from the condensate unit straight up, as high as necessary, but not higher than the maximum top of the pump. Ensure that the outlet pipe is not twisted or blocked.

Useful information Use of the non-return valve

1. To the installation
 - Insert the non-return valve into the drill hole
 - Turn 90° clockwise
2. To uninstall
 - Turn 90° anti-clockwise
 - Remove the non-return valve from the drill hole.

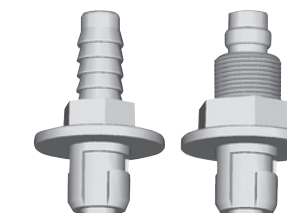

(4) To prevent the pump from draining and running dry, always connect the outlet pipe to a drain that is higher than the pump itself.

Useful information to avoid draining (siphoning)

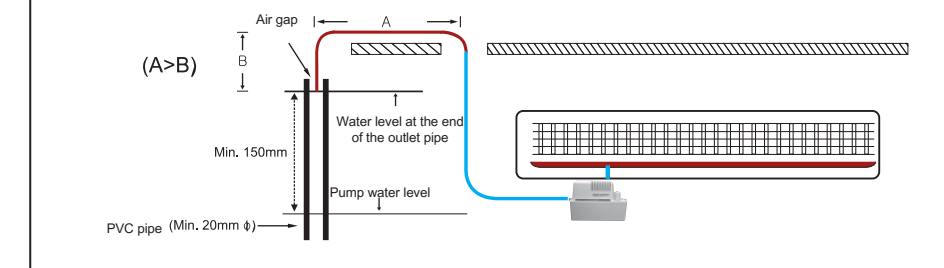

- (5) ⚠ Ensure that the power source voltage matches the pump requirement. Connect the power cable of the pump to a constant power source (no fan or other device that is operated intermittently). Do not connect the power cable of the air conditioner directly to the power cable of the pump or merge them. If the power cable of the pump is to be extended, use a cable use a cable with the same specification. All wiring should be carried out by a qualified service technician.
- (6) Once all the above tasks have been completed, please carry out a test run. Pour water into the pump reservoir and check that the pump is working properly.

Useful information about the safety switch

- ☞ The safety switch is designed to prevent the pump from overflowing if it is not working properly for various reasons.
- ☞ The cables of the safety switch, which originally come from our factory, are set to switch off the heat treatment/AC circuit. To do this, the supply wires should be connected in series with the low voltage thermostat circuit.
- ☞ All wiring should be carried out by a qualified service technician. Please observe the local regulations in your region.